

CUNIC homes



**TURN KEY - TENANT READY
INVESTOR HOUSE & LAND PACKAGE**

\$645,000

Lot 77, Hudson Grove Estate, New Norfolk

MYHOME PACKAGE
AVAILABLE

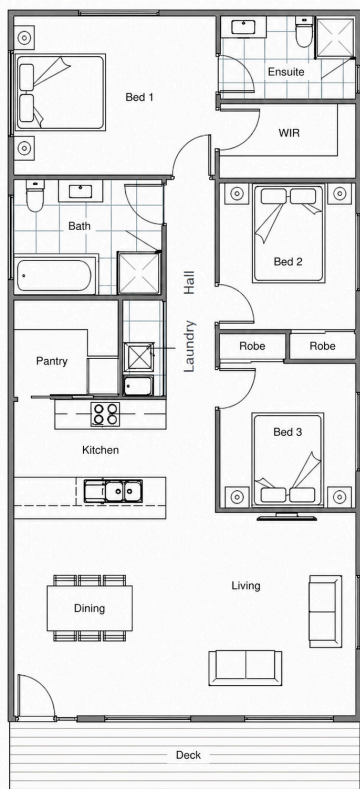

**DWELLING
SIZE:
Approx
113.31m²**

**BLOCK
SIZE:
Approx
709m²**



Sally Charleston

☎ 0415 107 420

📍 209 Elizabeth Street, Hobart

🌐 www.cunichomes.com.au

Pricing based on "M" class soil, Bal-LOW and maximum fall of 2000mm over the build area. Pricing includes allowance for driveway, service connections and all documentation and council approvals. Image depicts style only. Turn key items included.